

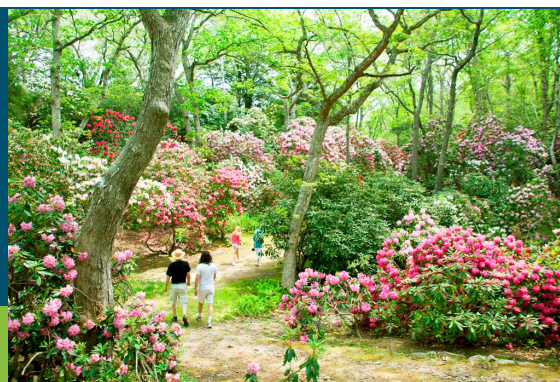

HERITAGE MUSEUMS & GARDENS

Top Ten "Must See" Spots at Heritage!



1. **The J.K. Lilly III Automobile Gallery:** Explore Heritage's superb collection of antique cars that illustrate the evolution of the automobile. Check out the newest acquisition on display - the iconic 1942 Willys MB Jeep!
2. **The McGraw Family Garden of the Senses:** Engage all your senses in this accessible and tranquil garden area that features a boardwalk, water features, and the Old East Mill, celebrating its 225th anniversary!
3. **The Hydrangea Gardens:** Stroll through the Cape Cod Hydrangea Society Display Garden and the North American Hydrangea Test garden to learn more about this iconic plant.
4. **The Labyrinth:** Relax, meditate, and commune with nature under the trees as you travel this winding pathway.
5. **The Special Exhibitions Gallery:** Discover the *Bountiful Bogs: The Massachusetts Cranberry Story* exhibit, featuring Heritage's newly acquired cranberry collection, and explore how this humble berry has fundamentally shaped the culture, economy, and environment of Cape Cod for hundreds of years. Opening May 16.
6. **The Wetu and Mush8n:** Experience a full-sized reproduction of a Wampanoag dwelling and a 12' dugout canoe you can sit in to learn more about what life was like for the Indigenous people who lived here pre-colonization.
7. **Hidden Hollow:** Splash, move, play, climb, create, explore, and more in this outdoor discovery area.
8. **Nature Trails:** Meander along some of the several miles of nature trails, rich with wildlife and the melodies of songbirds, that wind through the grounds.
9. **Dexter Display Garden:** Explore this two-acre garden that features an impressive collection of rhododendrons hybridized by noted horticulturist Charles O. Dexter who lived on this property from 1921-1943.
10. **The American Art & Carousel Gallery:** Enjoy a ride on the 1908 Looft carousel and view a variety of art and objects celebrating the many ways in which Cape Codders have interacted with the Atlantic Seaboard in our *Heritage Highlights* exhibit.

Visit The Shop at Heritage in its new location!

Become A Member!

Apply today's tickets to the cost of a membership today!

It only takes a moment to join at the Visitor Center on your way out or online: HeritageMuseums.org/membership. Members get free unlimited access during the main season, early entry on Member Mornings, plus so much more!

Visit heritagemuseums.org for more information



Receive \$7 off your purchase of Adventure Park tickets within 7 days of your Heritage visit by showing your dated receipt.

Upcoming Programs

- ❖ **Member Mornings** (members only)
Every Monday, Wednesday, & Friday, 9-10 am
- ❖ **Mother's Day** (free admission for mothers)
Sunday, May 11, 10 am-5 pm
Sponsored by Arbella Insurance Foundation and Cape Cod 5
- ❖  **Rhododendron Festival** May 16-26
10 am-5 pm
Sponsored by Arbella Insurance Foundation
- ❖ **Hydrangea Planting and Replanting Workshop**
Saturday, May 17, 10 am-12 pm
- ❖ **Resilience and Impact: The Odesa National Fine Arts Museum During Three Years of War**
Sunday, May 18, 10:30-11:30 am
Free with Admission
- ❖ **Community Day** (Free admission for Sandwich residents, veterans, & seniors 65 +)
Friday, May 23, 10 am-5 pm
Sponsored by Arbella Insurance Foundation and Cape Cod 5
- ❖ **Gearhead Garage**
Wednesday, May 28, 5-6:30 pm
- ❖ **Growing Hydrangeas in Containers Workshop**
Thursday, May 29, 5:30 - 7:30 pm
- ❖ **Opening of David Roger's Big Bugs Outdoor Sculpture Exhibit**
Saturday, May 31, 10 am
Meet the Artist 10-11 am and 1-3
- ❖  **53rd Heritage Annual Auto Show**
Saturday, June 7, 10 am-2 pm
Rain date: June 8, 10 am-2 pm
- ❖ **Lite Bites & Garden History Insights** (members only event)
Thursday, June 5, time TBD
- ❖ **Father's Day** (free admission for fathers)
Sunday, June 15, 10 am-5 pm
Sponsored by Arbella Insurance Foundation and Cape Cod

67 Grove Street • Sandwich, MA 508-888-3300

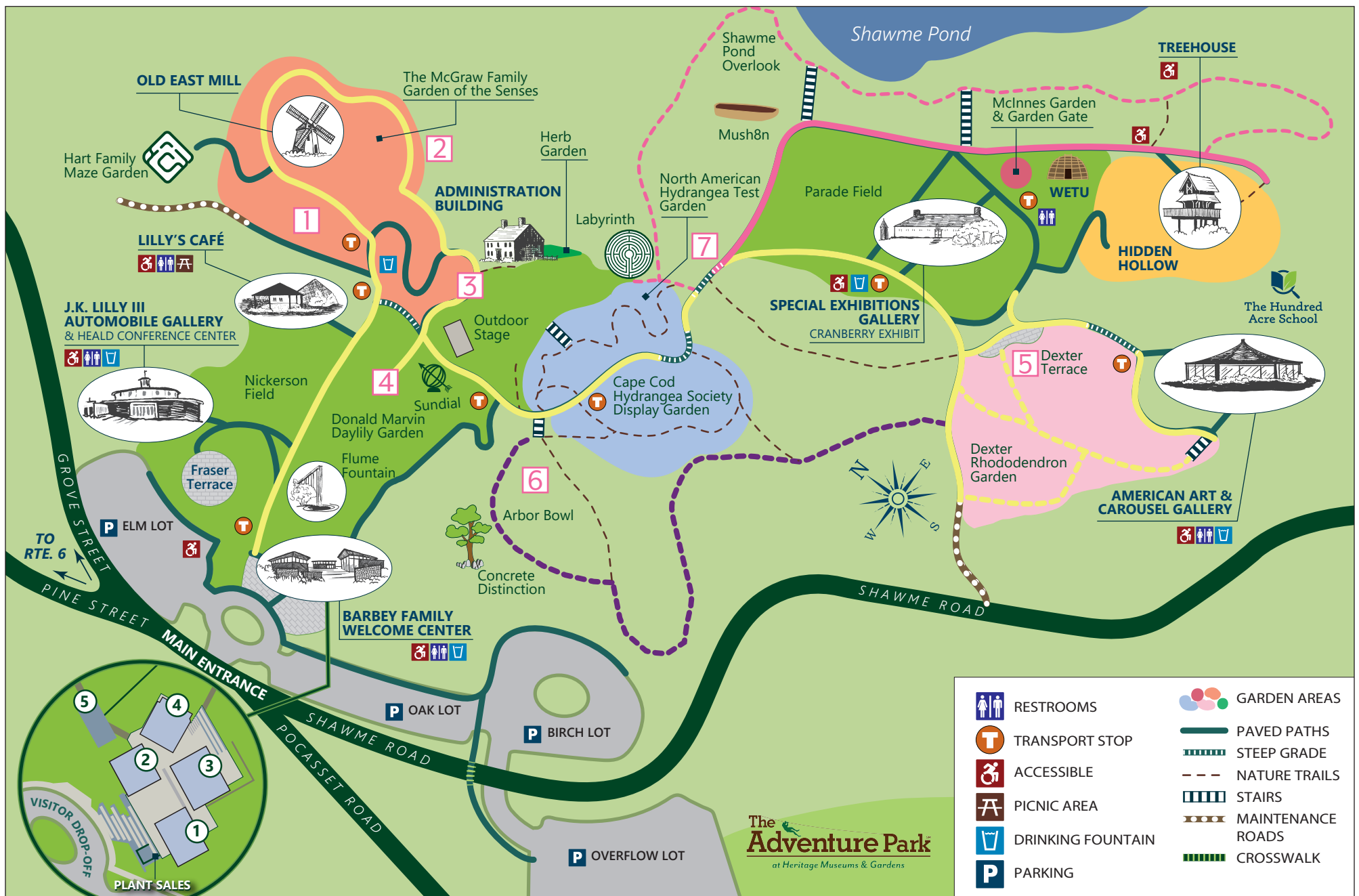

Barbey Family Welcome Center

- 1 The Shop at Heritage
- 2 Restrooms
- 3 K.A.H.R. Courtyard & Ticketing Pavilion
Lilly Family Board Room (lower level)
- 4 Clarissa S. Nye Visitor Center
- 5 Flume Plaza

Walking distances from the Welcome Center to:

- The J.K. Lilly III Automobile Gallery: 4 minutes
- The Special Exhibitions Gallery: 10 minutes
- The American Art and Carousel Gallery: 15 minutes

THANK YOU TO OUR SEASON SPONSOR:



May 16-26, 2025